

The logo for Fenix, featuring the word "Fenix" in a stylized, green, 3D font with a blue and green swoosh underline. The background is a faded image of a roller coaster track.

**Fenix**

**TRUSSES**  
**TRUSSES**



**INGENIERIA DE CALIDAD**

***QUALITY ENGINEERING***



**FEI VIX**

**EN EL MUNDO**

***IN THE WORLD***



Los pilares de nuestra identidad son garantizar productos de alta calidad, proporcionando un servicio serio, integral, eficaz y puntual.

Para llevar a cabo este compromiso, contamos con un equipo humano, con preparación especializada y con mas de 15 años de experiencia.

FENIX como fabricante garantiza:

- Calidad.
- Servicio de asistencia.
- Garantía directa del fabricante.

La calidad de FENIX es reconocida a nivel nacional e internacional.

En FENIX estamos especializados en desarrollar proyectos a medida.

Nuestras estructuras son compatibles a nivel europeo tanto en medias como en ensamblaje.

Todos nuestros productos están fabricados en nuestras instalaciones (España) y han sido certificados con las normativas vigentes [C € 89/392 EWG] [BGV C1, BGG 912].

*The pillars of our identity are to guarantee high quality products, delivering a serious service, comprehensive, efficient and precise.*

*To carry out this commitment, we count with a specialized team with more than 15 years experience.*

*FENIX like manufacturer guarantees:*

- Quality.*
- Technical assistance service.*
- Direct guarantee Manufacturer's.*

*The quality of FENIX is recognized nationally and internationally.*

*In FENIX we are specialized in developing customized projects.*

*Our structures are compatible to European level so much in measurements as in assembly.*

*All of our products are made at our facilities (Spain) and have been certified by force regulations [C € 89/392 EWG] [BGV C1, BGG 912].*





**FENIX**



**TRUSSES Y TORRES  
ESTRUCTURALES**

***TRUSSES & STRUCTURAL  
SYSTEMS***

# Trusses Serie 25



## Datos técnicos / Technical data

Aleación / Alloy	Al Si 6082 T6
Tubo principal / Main tube	50 x 2 mm
Tubo secundario / Brace	13 x 1,5 mm
Modo de unión / Joint	Cónica / Conic end

## SD-25 Paralelo / Parallel

Medidas disponibles / Available in	
Ref.	Kg.
SD-25 1 m	1,55
SD-25 2 m	2,70
SD-25 3 m	3,98

## ST-25 Triangular

Medidas disponibles / Available in	
Ref.	Kg.
ST-25 1 m	3,10
ST-25 1,5 m	4,70
ST-25 2 m	6,10
ST-25 2,5 m	7,75
ST-25 3 m	8,90

## Tabla de cargas / Loading list ST-25

Luz / Light (m)	3	4	5	6	7	8	9	10	11	12
Carga centrada / Centred load (kg)	413	319	251	188	156	135	110	90	73	52
Carga distribuida / Distributed load (Kg/m)	187	146	83	60	45	32	24	17	12	10



# Esquinas Serie 25 Corners Serie 25

## Paralelo / Parallel

25-D

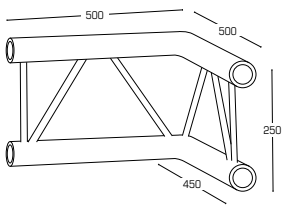

25-DP

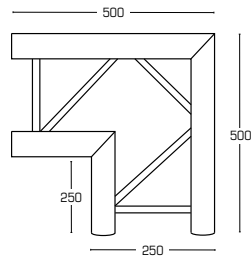

25-DT

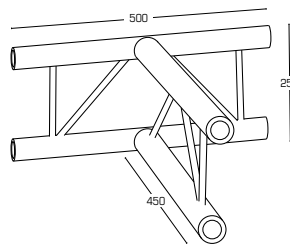

25-DD

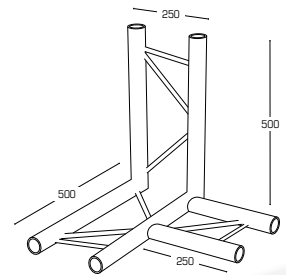

25-DM



## Triangular

25-T

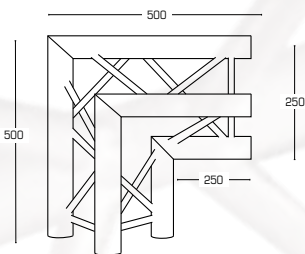

25-TP

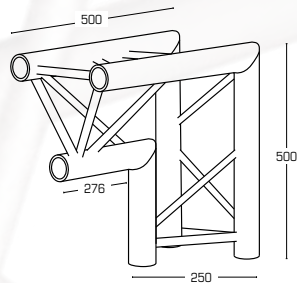

25-TI / 25-TD

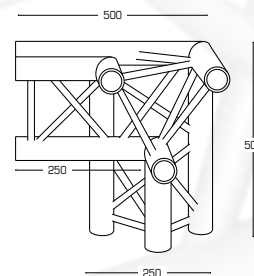

25-TX

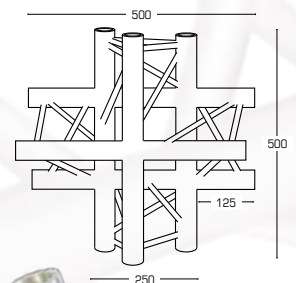

25-TTB

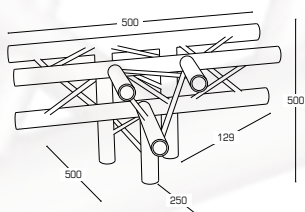

25-TT

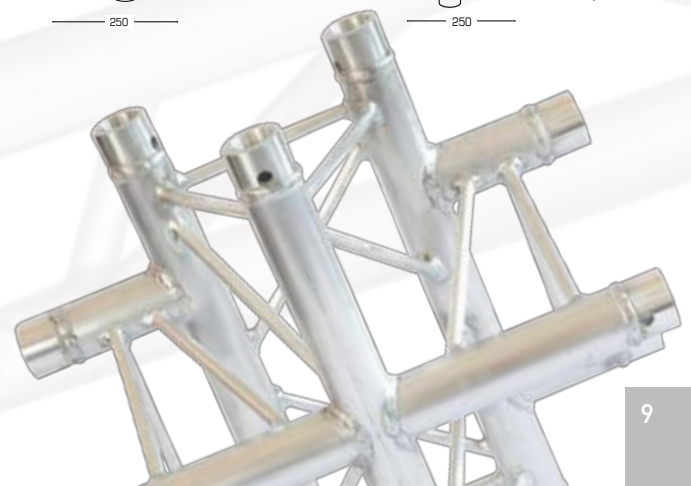
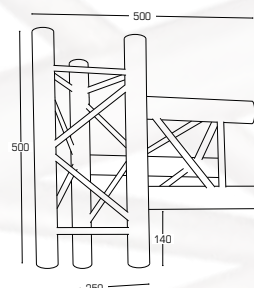

# Trusses Serie 29



Datos técnicos / Technical data	
Aleación / Alloy	Al Si 6082 T6
Tubo principal / Main tube	50 x 2 mm
Tubo secundario / Brace	16 x 2 mm
Modo de unión / Joint	Cónica / Conic end

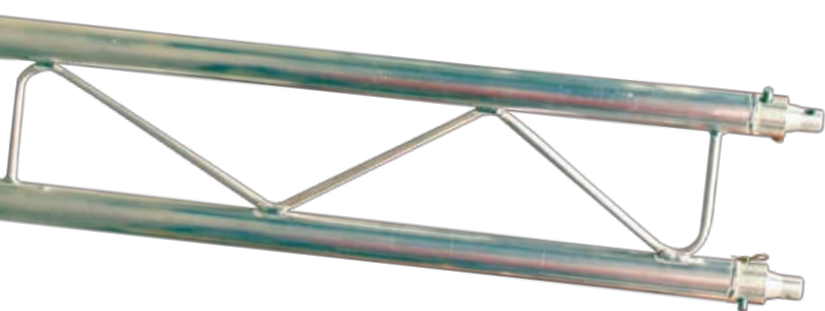

## SD-29 Paralelo / Parallel

Medidas disponibles / Available in	
Ref.	Kg.
SD-29 1 m	2,53
SD-29 2 m	4,51
SD-29 3 m	6,40

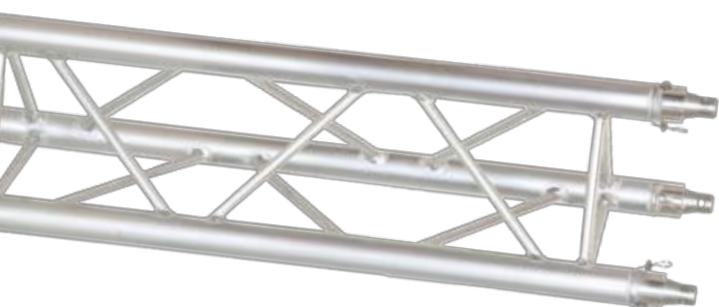

## ST-29 Triangular

Medidas disponibles / Available in	
Ref.	Kg.
ST-29 1 m	3,35
ST-29 1,5 m	4,90
ST-29 2 m	6,55
ST-29 2,5 m	7,95
ST-29 3 m	9,75

### Tabla de cargas / Loading list ST-29

Luz / Light (m)	3	4	5	6	7	8	9	10	11	12
Carga centrada / Centred load (kg)	586	548	512	456	430	329	289	240	195	150
Carga distribuida / Distributed load (Kg/m)	400	310	196	140	109	78	56	41	32	20



## SQ-29 Cuadrado / Square

Medidas disponibles / Available in	
Ref.	Kg.
SQ-29 0,5 m	3,80
SQ-29 1 m	4,50
SQ-29 1,5 m	6,70
SQ-29 2 m	8,75
SQ-29 2,5 m	10,40
SQ-29 3 m	13,10

### Tabla de cargas / Loading list SQ-29

Luz / Light (m)	3	4	5	6	7	8	9	10	11	12	13	14	15	16
Carga centrada / Centred load (kg)	620	570	540	480	450	345	300	260	240	200	180	160	140	120
Carga distribuida / Distributed load (Kg/m)	470	375	302	231	189	166	241	108	91	76	62	51	43	30





# Esquinas Serie 29

## Corners Serie 29

### Paralelo / Parallel

29-D

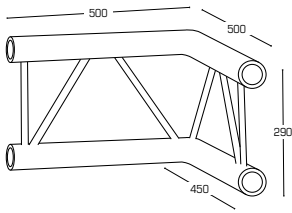

29-DP

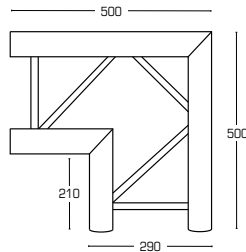

29-DT

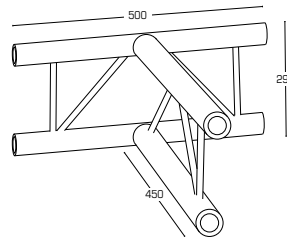

29-DD

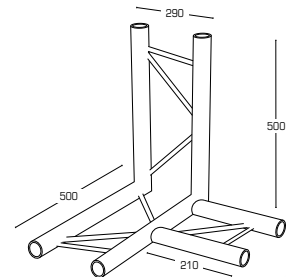

### Triangular

29-T

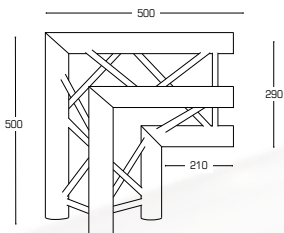

29-TP

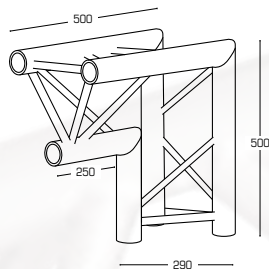

29-TI / 29-TD

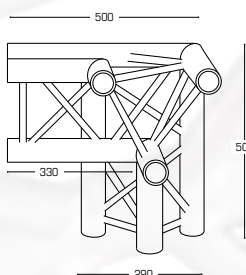

29-TX

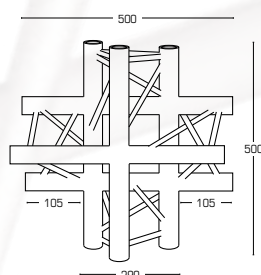

29-TTB

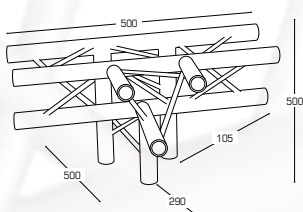

29-TT

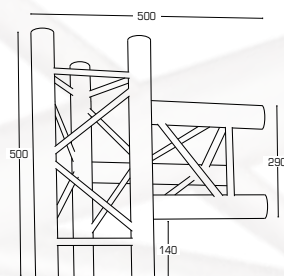

### Cuadrado / Square

SQB-29 / 29-CH

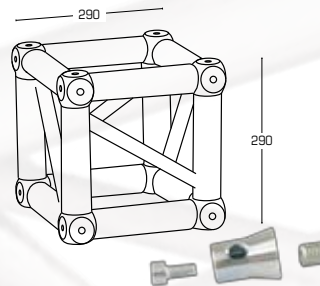

29-Q

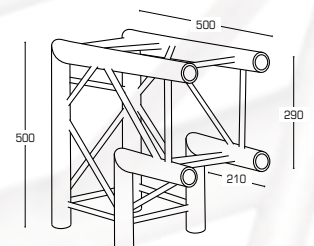

29-QB

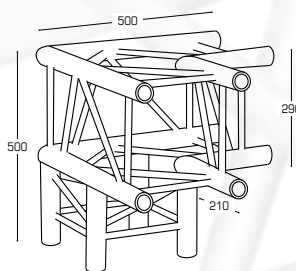

29-QT

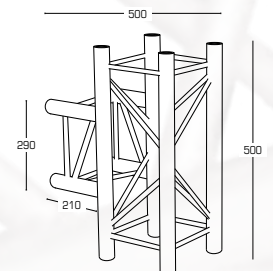

29-QTB

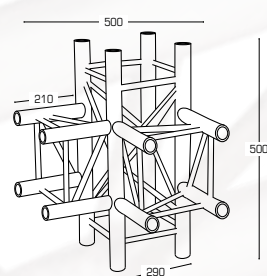

29-QX

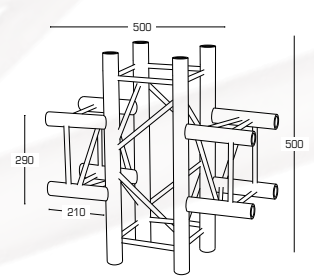

# Trusses Serie 40

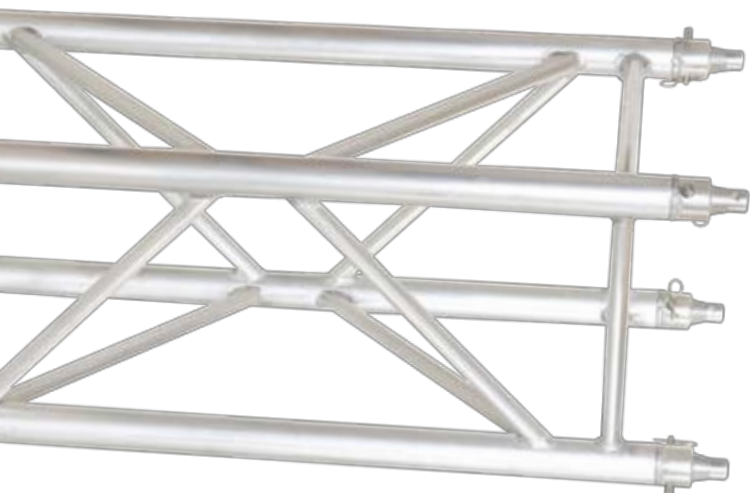

## Datos técnicos / Technical data

Aleación / Alloy	Al Si 6082 T6
Tubo principal / Main tube	50 x 2 mm
Tubo secundario / Brace	25 x 2 mm
Modo de unión / Joint	Cónica / Conic end

## SQ-40 Cuadrado / Square

### Medidas disponibles / Available in

Ref.	Kg.
SQ-40 1 m	5,90
SQ-40 2 m	10,20
SQ-40 3 m	15,10

## Tabla de cargas / Loading list SQ-40

Luz / Light (m)	3	4	5	6	7	8	9	10	11	12	13	14	15	16
Carga centrada / Centred load (kg)	720	685	605	591	545	493	470	436	409	398	374	369	351	310
Carga distribuida / Distributed load (Kg/m)	625	570	410	350	286	254	218	186	156	134	106	79	67	56

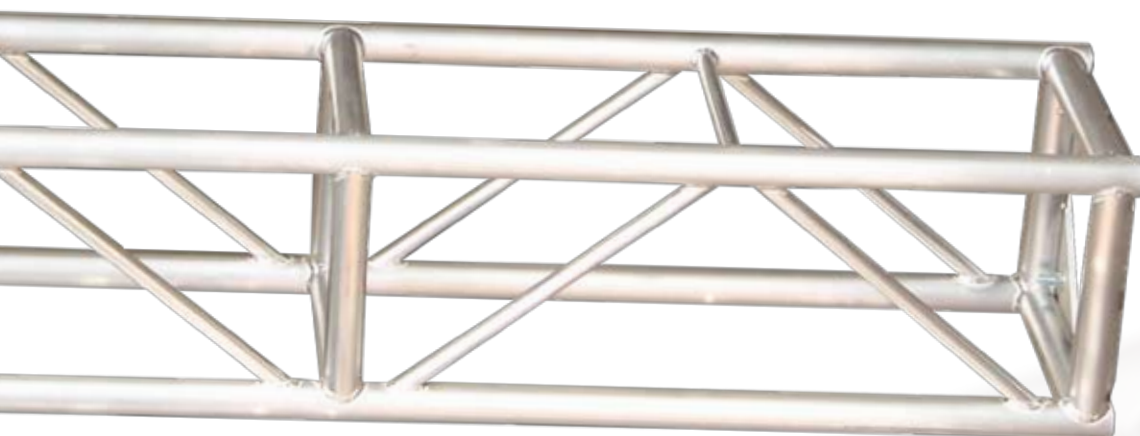

## SQP-40 Cuadrado / Square

### Datos técnicos / Technical data

Aleación / Alloy	Al Si 6082 T6
Tubo principal / Main tube	50 x 2 mm
Tubo secundario / Brace	25 x 2 mm
Modo de unión / Joint	Plancha + Tornillo / Screw

### Medidas disponibles / Available in

Ref.	Kg.
SQP-40 1 m	16
SQP-40 2 m	26
SQP-40 3 m	30

## Tabla de cargas / Loading list SQP-40

Luz / Light (m)	3	4	6	8	10	12	14	16	18
Carga centrada / Centred load (kg)	1100	950	890	715	605	565	480	360	230
Carga distribuida / Distributed load (Kg/m)	700	570	480	320	256	180	90	70	40



# Esquinas Series 40, 45

## Corners Series 40, 45

### Cuadrado / Square 40

SQB-40 / 40-CH

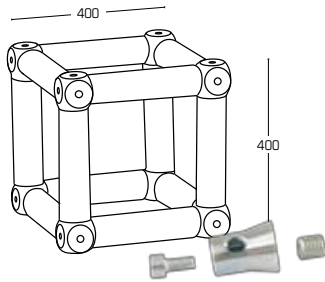

40-Q

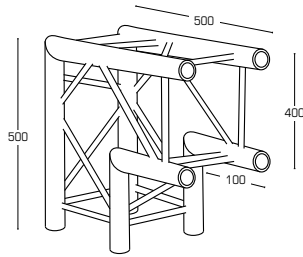

40-QB

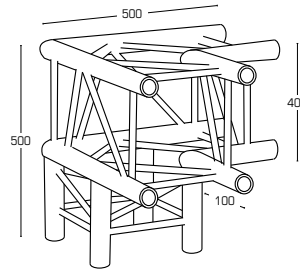

40-QTB

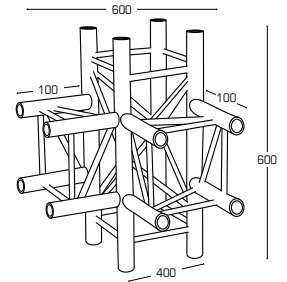

40-QT

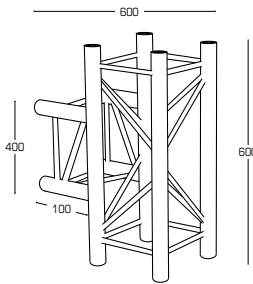

40-QX

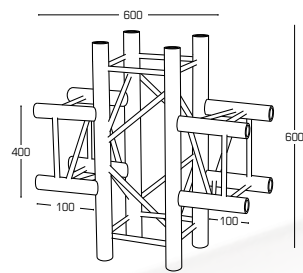

### Triangular 45

45-T

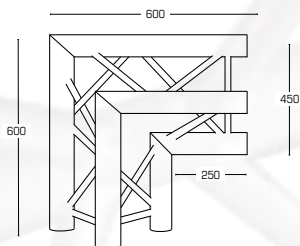

45-TP

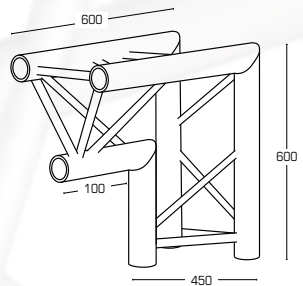

45-TI

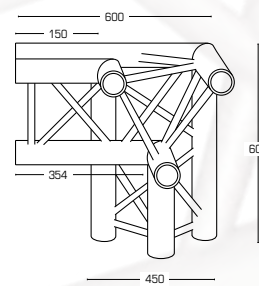

45-TX

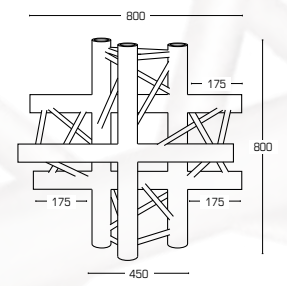

45-TT

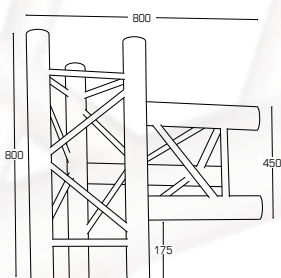

45-TTB

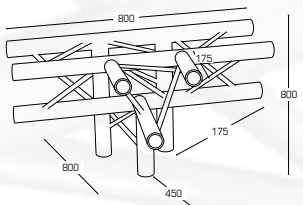

# Trusses Serie 45

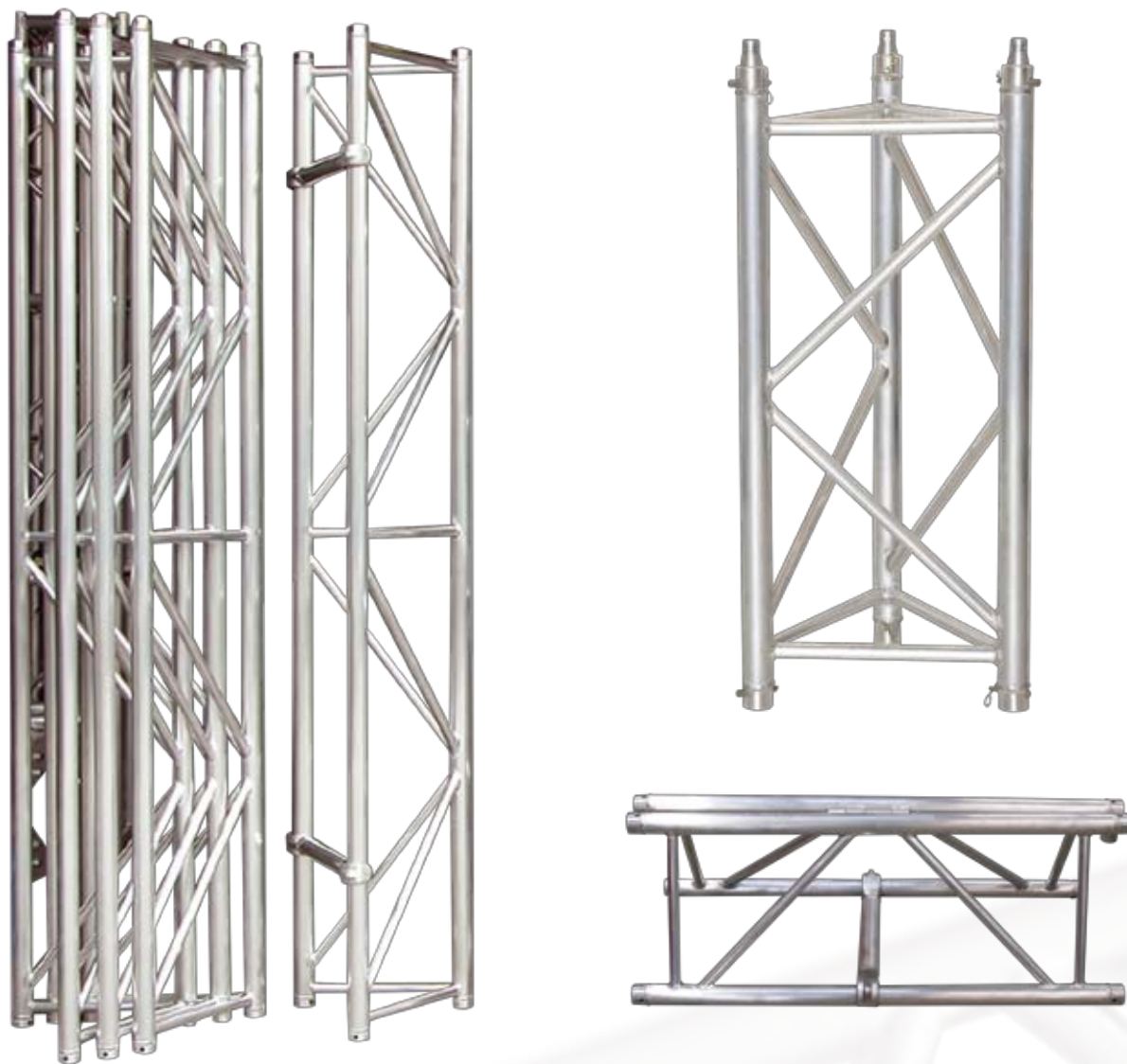

ST-45 / STA-45 / STP-45 Triangular



**Datos técnicos / Technical data**

Aleación / Alloy	Al Si 6082 T6
Tubo principal / Main tube	50 x 2 mm
Tubo secundario / Brace	25 x 2 mm
Modo de unión / Joint	Cónica / Conic end

**Medidas disponibles / Available in**

Ref.	Kg.	Kg.	Kg.
ST-45 1 m	4,1	4,5	4,4
ST-45 2 m	8,2	8,3	8,4
ST-45 3 m	11,6	12,1	12,2

**Tabla de cargas / Loading list ST-45 / STA-45 / STP-45**

Luz / Light (m)	3	5	7	9	11	13	15	18
Carga centrada / Centred load (kg)	650	598	549	501	359	258	180	99
Carga distribuida / Distributed load (Kg/m)	500	289	181	100	59	36	20	11

# Trusses Serie 52

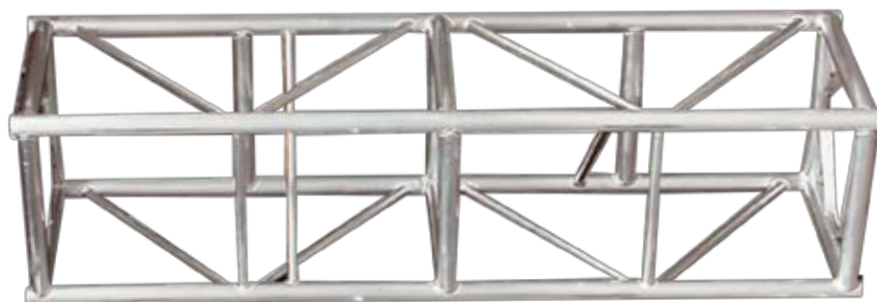

SQ-52 Cuadrado / Square



Datos técnicos / Technical data	
Aleación / Alloy	Al Si 6082 T6
Tubo principal / Main tube	50 x 3,5 mm
Tubo secundario / Brace	25 x 3 mm
Modo de unión / Joint	Plancha + Tornillo / Screw

Medidas disponibles / Available in	
Ref.	Kg.
SQ-52 1 m	20
SQ-52 2 m	30
SQ-52 3 m	38

Tabla de cargas / Loading list SQ-52

Luz (m)	3	4	6	8	10	12	14	16	18
Carga centrada (kg)	1500	1400	1220	850	640	597	500	349	280
Carga uniforme distribuida (Kg/m)	760	670	510	430	280	200	105	89-	50

# Trusses Serie 62



SQ-62 Cuadrado / Square

Datos técnicos / Technical data	
Aleación / Alloy	Al Si 6082 T6
Tubo principal / Main tube	50 x 3,5 mm
Tubo secundario / Brace	25 x 2 mm
Modo de unión / Joint	Cónica / Conic end

Medidas disponibles / Available in	
Ref.	Kg.
SQ-62 1 m	12
SQ-62 2 m	21
SQ-62 2,4 m	27
SQ-62 3 m	32

Tabla de cargas / Loading list SQ-62

Luz / Light (m)	3	6	9	12	15	18
Carga centrada / Centred load (kg)	980	870	800	740	540	300
Carga distribuida / Distributed load (Kg/m)	380	300	210	100	76	60

# Accesorios

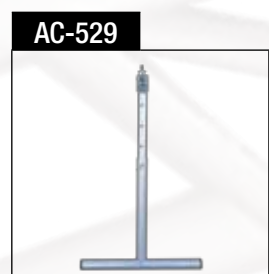
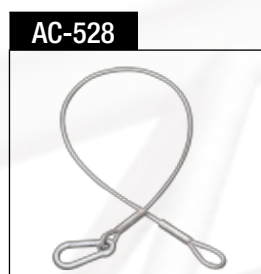
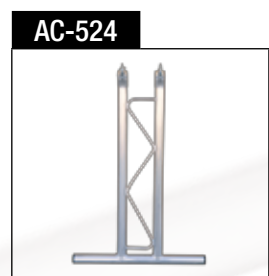
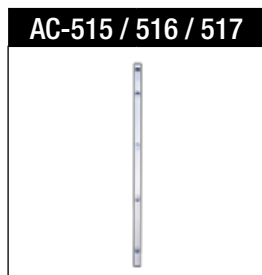
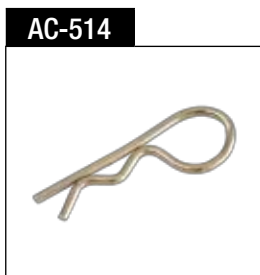

# Accessories

CE

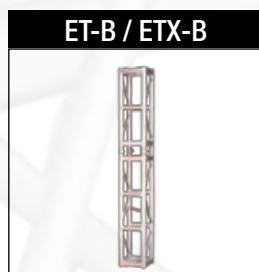
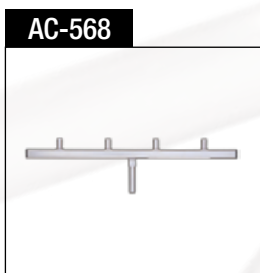
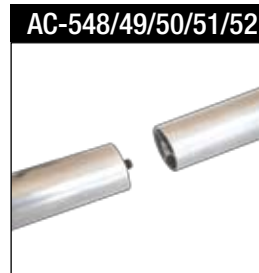

# Circulares / Circulars

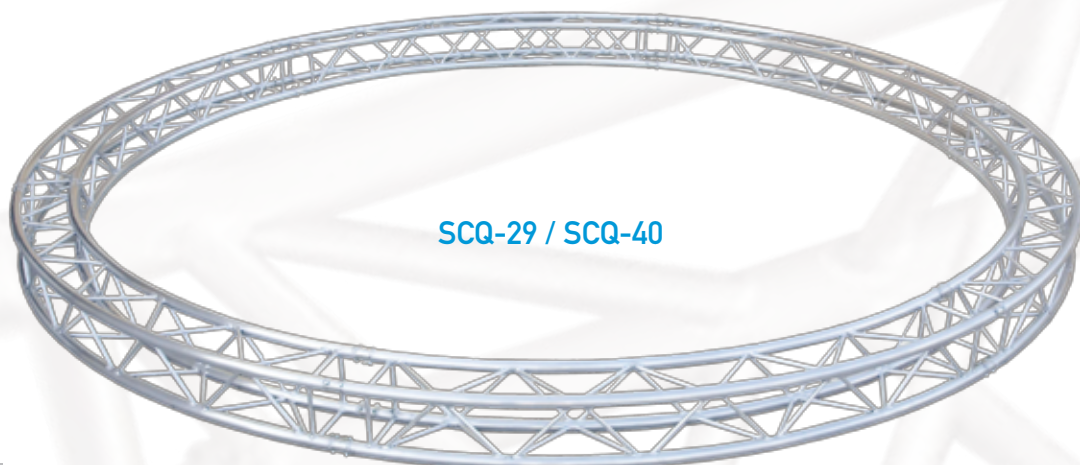
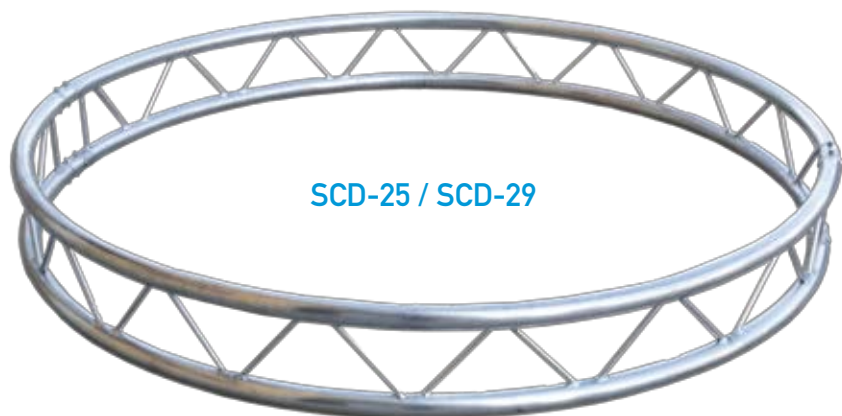

## Datos técnicos / Technical data

Aleación / Alloy	Al Si 6082 T6
Tubo principal / Main tube	50 x 2 mm
Tubo secundario / Brace	16 x 2 mm
Modo de unión / Joint	Cónica / Conic end



# TR-657 / 659

## Datos técnicos / Technical data

Aleación / Alloy	Al Si 6082 T6
Tubo principal / Main tube	50 x 3,5 mm
Tubo secundario / Brace	16 x 2 mm
Modo de unión / Joint	Cónica / Conic end



## TR-657

### Ficha técnica / Technical specifications

Altura máxima / Maximum height	7,00 m
Carga máxima / Maximum load	650 kg
Altura plegada / Folded height	1,1 m
Área de trabajo / Working area	2,8 x 2,8 m
Peso / Weight	93 kg
Cabestrante / Winch	1200 kg

## TR-659

### Ficha técnica / Technical specifications

Altura máxima / Maximum height	9,00 m
Carga máxima / Maximum load	650 kg
Altura plegada / Folded height	1,1 m
Área de trabajo / Working area	2,8 x 2,8 m
Peso / Weight	109 kg
Cabestrante / Winch	1200 kg

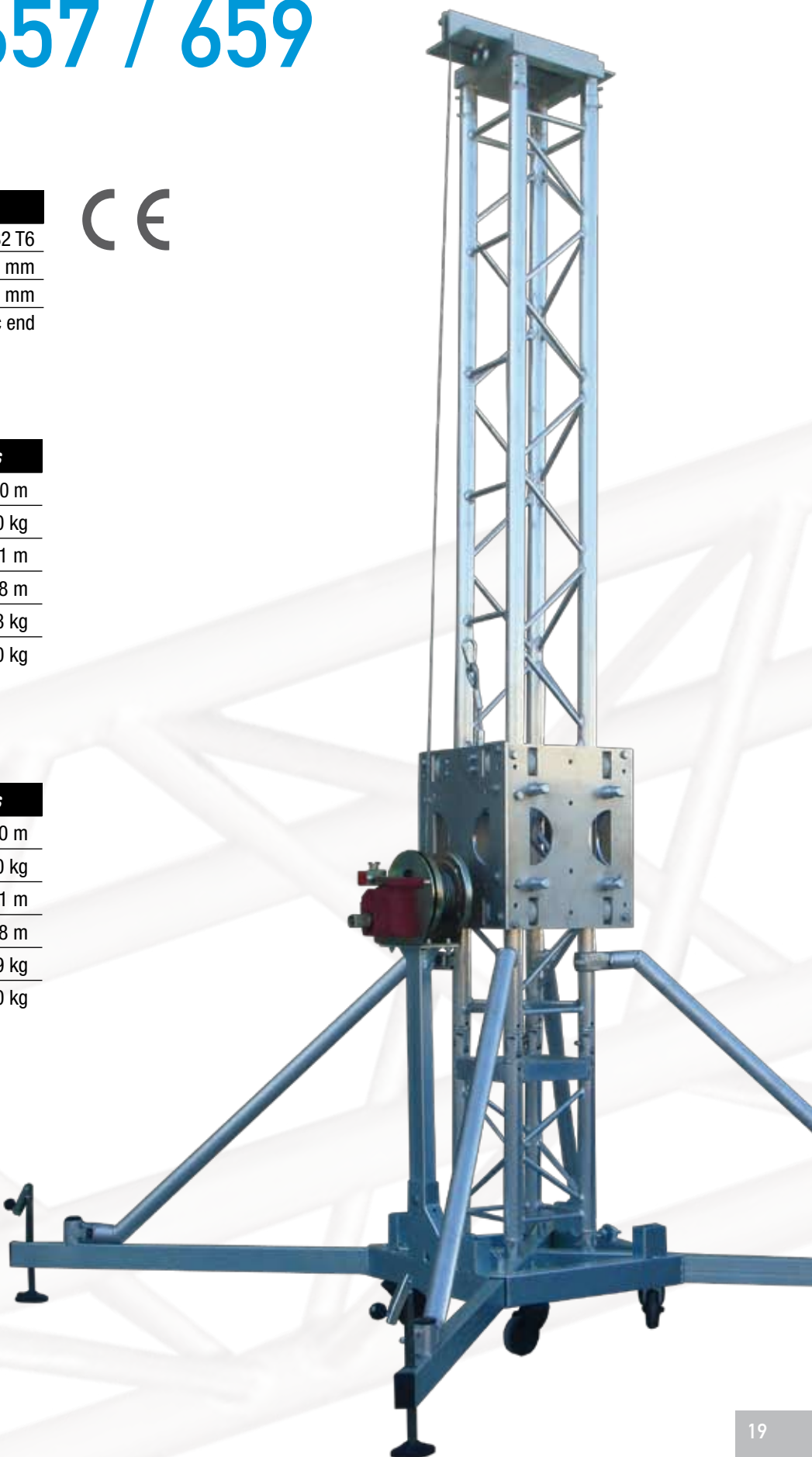

# TR-1009 / 1012



## Datos técnicos / Technical data

Aleación / Alloy	Al Si 6082 T6
Tubo principal / Main tube	50 x 3,5 mm
Tubo secundario / Brace	25 x 2 mm
Modo de unión / Joint	Plancha + Tornillo / Screw

## TR-1009

### Ficha técnica / Technical specifications

Altura máxima / Maximum height	9,00 m
Carga máxima / Maximum load	1.500 kg
Altura plegada / Folded height	1,1 m
Área de trabajo / Working area	4 x 4 m
Peso / Weight	190 kg

## TR-1012

### Ficha técnica / Technical specifications

Altura máxima / Maximum height	12,00 m
Carga máxima / Maximum load	1.500 kg
Altura plegada / Folded height	1,1 m
Área de trabajo / Working area	4 x 4 m
Peso / Weight	208 kg



## CONDICIONES GENERALES DE VENTA

### 1. PEDIDOS

- Deberán ser efectuados por escrito (mediante fax ó e-mail), indicando claramente los modelos, de acuerdo con nuestras referencias mostradas en el catálogo.

- Los pedidos deberán estar sellados y firmados por el cliente o persona autorizada. En cualquier caso, la recepción de la mercancía por el cliente se considerará como confirmación y aceptación del pedido.

- No existe pedido mínimo.

- FENIX se reserva el derecho a modificar el diseño o las características de los productos sin previo aviso, no haciéndose responsable de los posibles errores tipográficos que pudieran aparecer en este catálogo.

### 2. FORMA DE PAGO

- Los pagos deben ser efectuados libre de cargos, al contado, por anticipado, mediante ingreso en efectivo o transferencia bancaria. Nota: Enviar por fax/e-mail justificante del pago realizado. No se aceptan talones. Los gastos ocasionados por la forma de pago escogida por el cliente correrán a cargo del mismo.

- FENIX se reserva la propiedad y titularidad de los productos suministrados hasta que el cliente efectúe el pago íntegro de los mismos.

### 3. ENVÍOS-PORTES

- La mercancía viaja por cuenta y riesgo del comprador.

- En caso de envíos a portes debidos, éste se realizará por la agencia que el comprador solicite; en caso de envíos a portes pagados FENIX se reserva el derecho de enviarla por la agencia que considere oportuna.

- Toda reclamación por robo y daños en el transporte o demoras en la entrega, deberá hacerse por el destinatario ante la agencia de transportes dentro de las 24 horas siguientes a la entrega de la mercancía. Nota: Igualmente deberán informar a FENIX de la reclamación realizada a la agencia.

- Transcurridos 3 días desde la fecha de recepción de la mercancía por el cliente, FENIX no admitirá ninguna reclamación referente a cantidades, artículos incorrectos, falta de accesorios, etc.

### 4. DEVOLUCIÓN DE MERCANCÍAS

- No será admitida ninguna devolución de mercancía sin nuestra autorización expresa por escrito.

- Todas las devoluciones deberán ser efectuadas a portes pagados (debidamente embalado para evitar su deterioro).

- El artículo devuelto será abonado con una depreciación del 5 al 15%, en concepto de manipulación, revisión y gestiones administrativas.

- Si en algún caso excepcional acordamos admitir la devolución de algún artículo, éste deberá ser actual, estar en perfectas condiciones y con su embalaje original, manuales y accesorios.

### 5. GARANTÍA

- Todos nuestros artículos están garantizados contra cualquier defecto de fabricación, por un periodo de 24 meses fecha factura.

- La garantía cubre únicamente la reposición de las partes defectuosas y la mano de obra.

- FENIX no se hará cargo, en ningún caso, de los daños de cualquier naturaleza que pudieran derivarse de una inadecuada utilización o del desgaste normal del producto; Así como aquellos productos que hayan sufrido modificaciones por parte del cliente sin el consentimiento expreso de FENIX.

- Los portes serán siempre a cargo del comprador. Los envíos para reparación en garantía deben ser efectuados a portes pagados y deberán incluir una nota detallada con las anomalías o averías observadas. Todo paquete recibido a portes debidos será rechazado en recepción.

- El servicio técnico tiene establecido un cargo mínimo por reparación y presupuesto, que confirmaremos en cada caso.

### 6. JURISDICCIÓN

Comprador y vendedor quedan sometidos a la jurisdicción de los Juzgados y Tribunales de Valencia (España).

## GENERAL SALES CONDITIONS

### 1. ORDERS

- Any order implies the acceptance of our sale conditions. All orders shall be made in writing (by fax or e-mail).

- Orders will have to be signed and stamped by the buyer. Acceptance of delivery of Goods shall be deemed conclusive evidence of the Buyers acceptance of these Conditions.

- There is not a minimum Purchase.

- FENIX reserves all rights to make changes as far as construction, weight and dimension without further notice, not being made responsible for any press mistakes that may appear in this catalogue.

### 2. PAYMENTS

- Customer order can only be accepted against advance payment by bank transfer free of any charge to our account. The expenses generated by a payment condition selected from the BUYER are at his charge. Note: For other way of payment we can charge a general administration fee.

- All goods will remain the property of FENIX until the price of such goods has been paid in full.

- FENIX may at any time suspend the provision of the goods if the buyer is late in making any payment due to FENIX.

### 3. DELIVERY

- The buyer is responsible for the freight and risks of the merchandise.

- The method of dispatch may be selected by the customer. Without any shipping instructions from the customer, we reserve us the right to arrange the dispatch by any forwarder/courier of our choice.

- The Buyer shall inspect the Goods immediately upon receipt. Any complaints regarding damage, delays or loss must be forwarded to the carrier, as well to FENIX, in written form within 24h from the receipt of the goods. Complaints of suspected bad packing must be forwarded to FENIX on the date of receipt.

- FENIX will not accept any reclamation regarding quantity, missing accessories or incorrect articles after 3 days since the customer received the goods.

### 4. RETURN OF GOODS

- No goods will be admitted in return without a written authorization from FENIX.

- The freight for returning the goods will be paid by the customer, who will make sure the goods are returned with a reinforced packing so that they arrive in perfect conditions.

- If FENIX were to, exceptionally, accept any article in return, it would have to be in perfect conditions, be returned in its original packing and it has to be a currently catalogued product.

- The returned goods will be refunded with a depreciation of 5 to 15% due to the extra handling, examination and paperwork.

### 5. WARRANTY

- FENIX warrants that goods shall be free from defects in material and workmanship for a period of 24 months from the date of Shipment unless otherwise specified.

- This guarantee exclusively covers the replacement of defective parts and working hours.

- This warranty does not extend to any of the product: which has been:

- Subjected to misuse, neglect, accident or abuse.

- Improperly repaired, or altered or modified in any way.

- Incorrect operated; used in violation of instructions furnished by FENIX.

- For the normal wear of the product.

- Defective goods must be returned to FENIX carriage paid and will have to include a written specification of the anomalies and damages observed.

- In case of replacements of parts manufactured by third parties, the guarantee period will be decided by the manufacturer of each part.

- In case of products that have been manufactured by FENIX according to buyer's specifications, drawings or models, FENIX cannot be responsible for the technical quality but its precise execution. In any case, these products are not guaranteed.

- The Technical Service at FENIX has a minimum charge established, as per estimation and repairing, that will be confirmed in each case.

FENIX is not liable for personal injury or material damage resulting from negligence, incorrect use, adaptation or maintenance of the goods.

### 6. APPLICABLE LAW, JURISDICTION

These terms and conditions shall be governed by and construed in accordance with Spanish law. Disputes arising in connection with these terms and conditions shall be subject to the exclusive jurisdiction of the Spanish courts.



# FENIX

[www.fenixlt.es](http://www.fenixlt.es)  
[info@fenixlt.es](mailto:info@fenixlt.es)  
[export@fenixlt.es](mailto:export@fenixlt.es)

**ROLLSPEED, S.L.**  
Camino Alquerieta, 10 • Pol. Ind. Massanassa  
46470 • Massanassa (Valencia), Spain  
Tel.: +34 96 125 08 55 • Fax: +34 96 125 13 05



**UNIÓN EUROPEA**  
Fondo Europeo  
de Desarrollo Regional  
*Una manera de hacer Europa*